

SET-UP STEPS

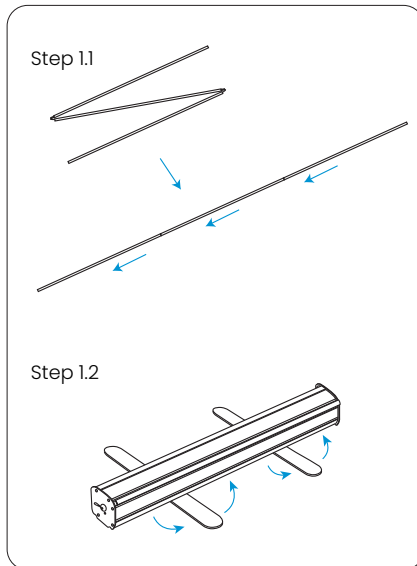

Step 1.1: Extend the pole.
Step 1.2: Rotate the feet until perpendicular to the base.

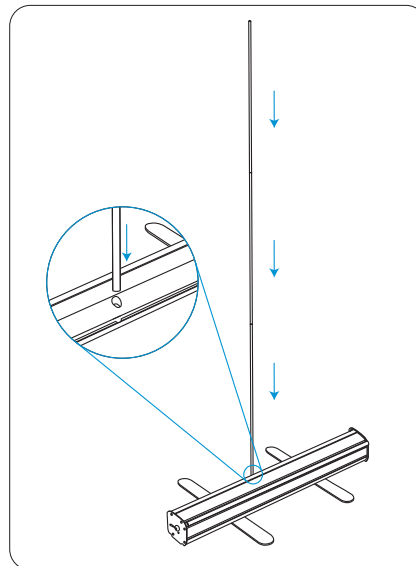

Step 2: Insert the pole into the hole at the back of the base.

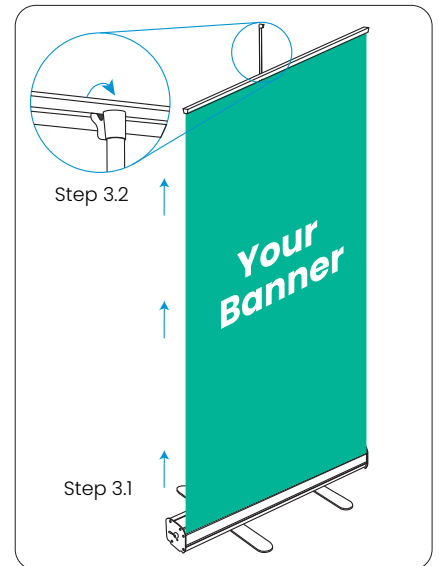

Step 3.1: Slowly pull the banner up from the base.
Step 3.2: Attach the header bar to the top of the pole.

REPLACEMENT STEPS

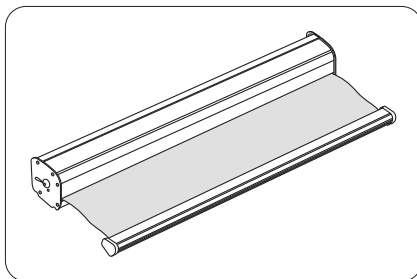

Step 1: Slowly pull the banner all the way out of the base.

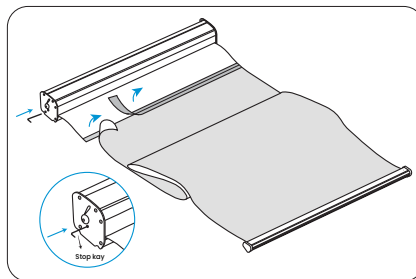

Step 2: Insert the hex key into the small hole on the side of the base and peel off the banner from the leader sheet.

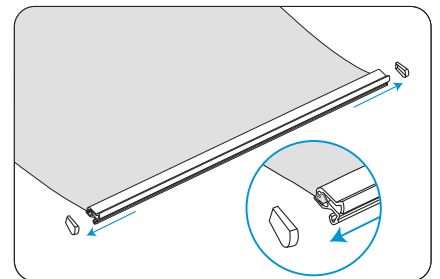

Step 3: Remove the two plastic inserts at each end of the header bar.

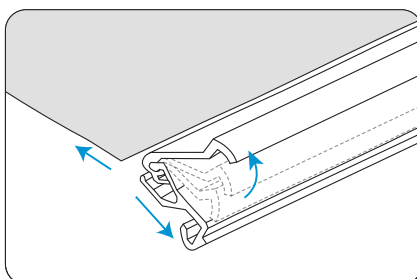

Step 4: Pry the header bar open. Remove the old banner and place the new one into it.

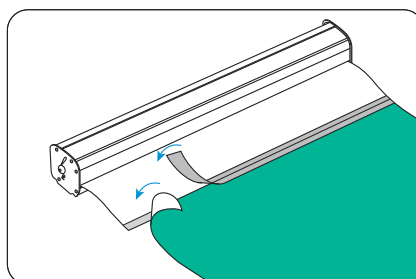

Step 5: Fix the banner onto the leader sheet with adhesive tape in a position identical to the previous one.

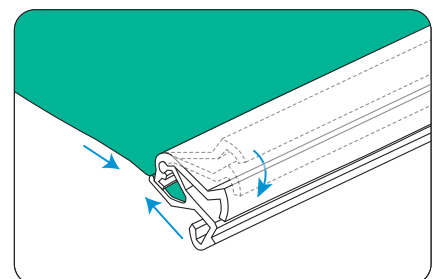

Step 6: Press down on the header bar to clamp the banner in place.

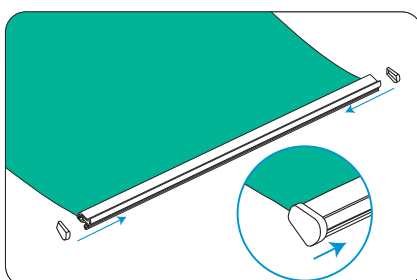

Step 7: Reattach the plastic end caps to each end of the header bar.

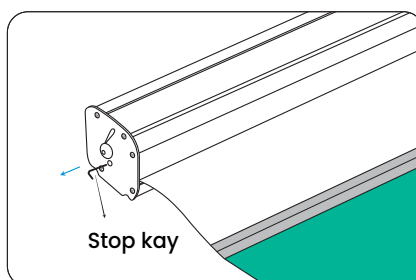

Step 8: Remove the hex key from the base.

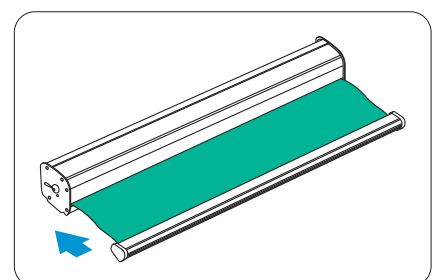

Step 9: Slowly slide your banner back into the base.