

Perforated Car Window Decals

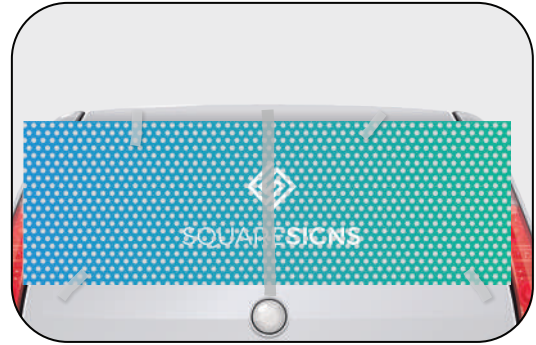

Step 1: Wipe the surface clean.



Step 2: Align the decal on the surface and create a hinge down the center with masking tape.

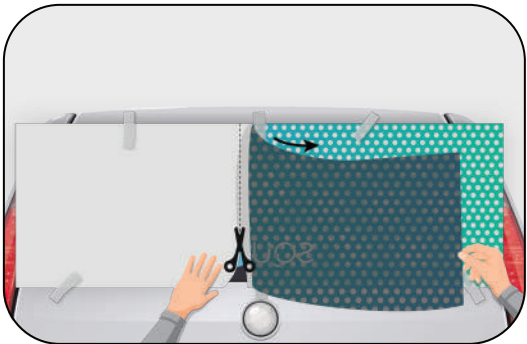

Step 3: Lift one half of the decal, peel back the liner to the hinge and cut it.

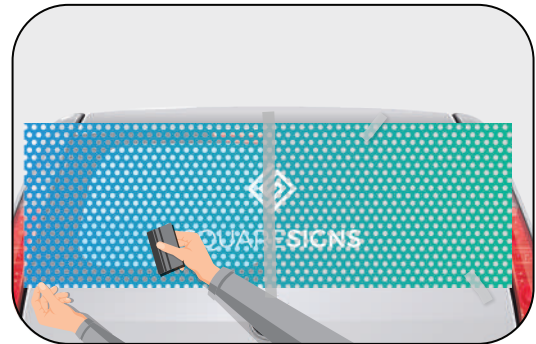

Step 4: Apply the exposed part of the decal from the center outward.

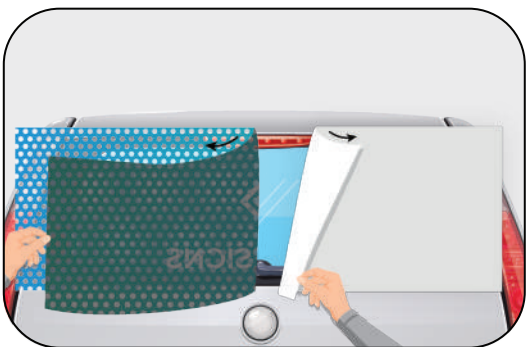

Step 5: Remove the hinge and peel off the remaining liner.

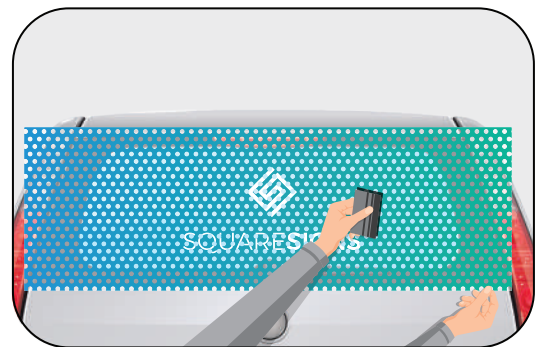

Step 6: Apply the other half from the center outward.

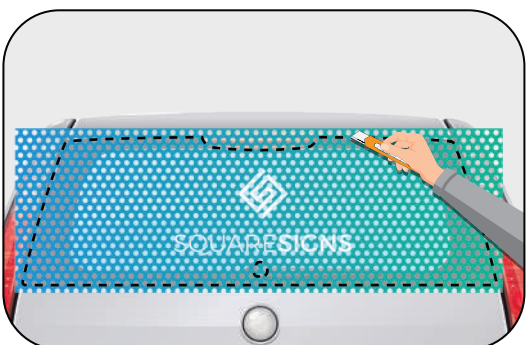

Step 7: Use a razor to carefully trim any excess material around complex shapes.



Step 8: Go over the edges with a heat gun for better adhesion to the glass. (This step is optional.)