

Installation Guide For Command Strips

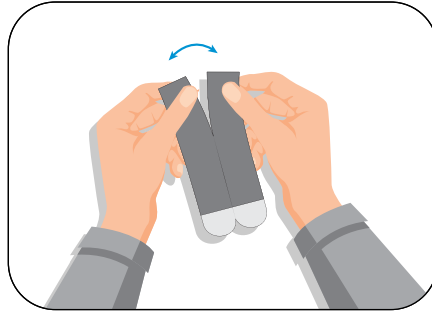

Step 1: Make sure the application surface is clean.



Step 2: Separate the pair of command strips from each other.

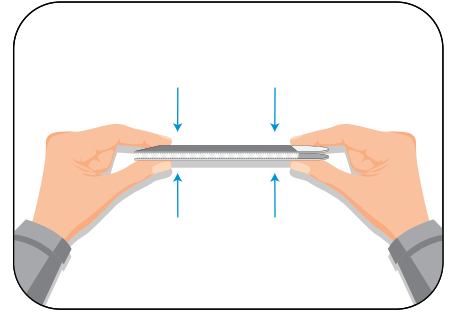

Step 3: Attach the velcro faces of the separated strips to each other.

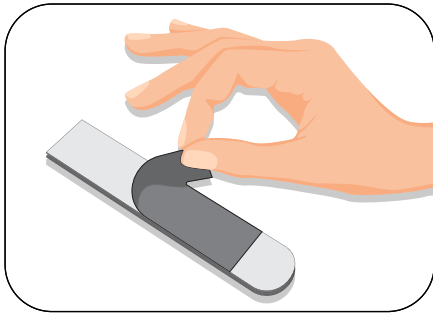

Step 4: Peel off the protecting backing off one of the strips.

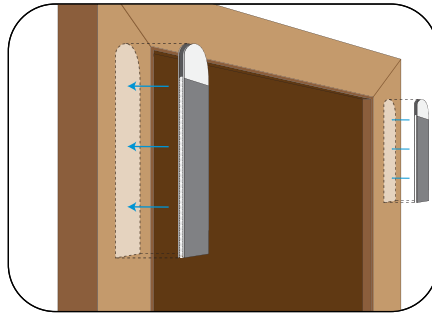

Step 5: Adhere the exposed backing of the strip to the back of the sign.

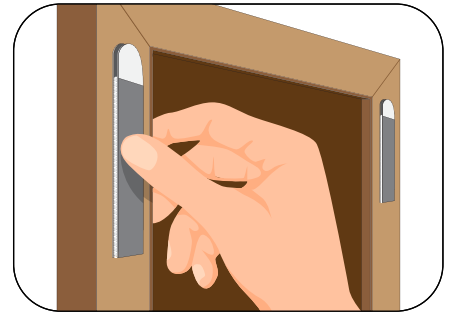

Step 6: Press firmly on the back of the command strips to bind them to the sign.

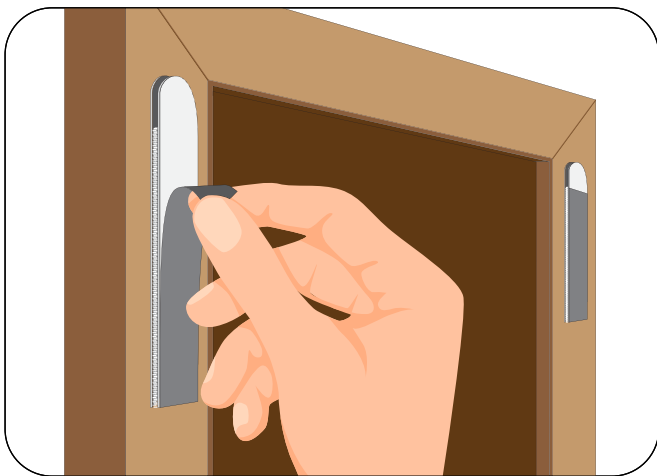

Step 7: Peel off the protective backing off the other command strips.

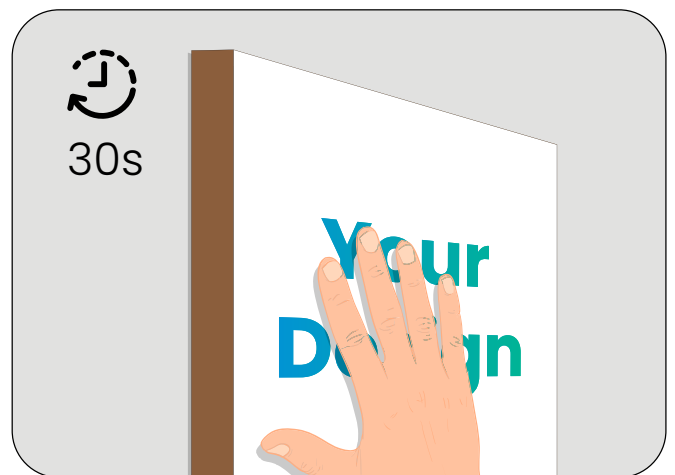

Step 8: Attach your sign to the wall by pressing firmly on the product for at least 30 seconds.