

Backlit SEG Fabric Display Installation Guide

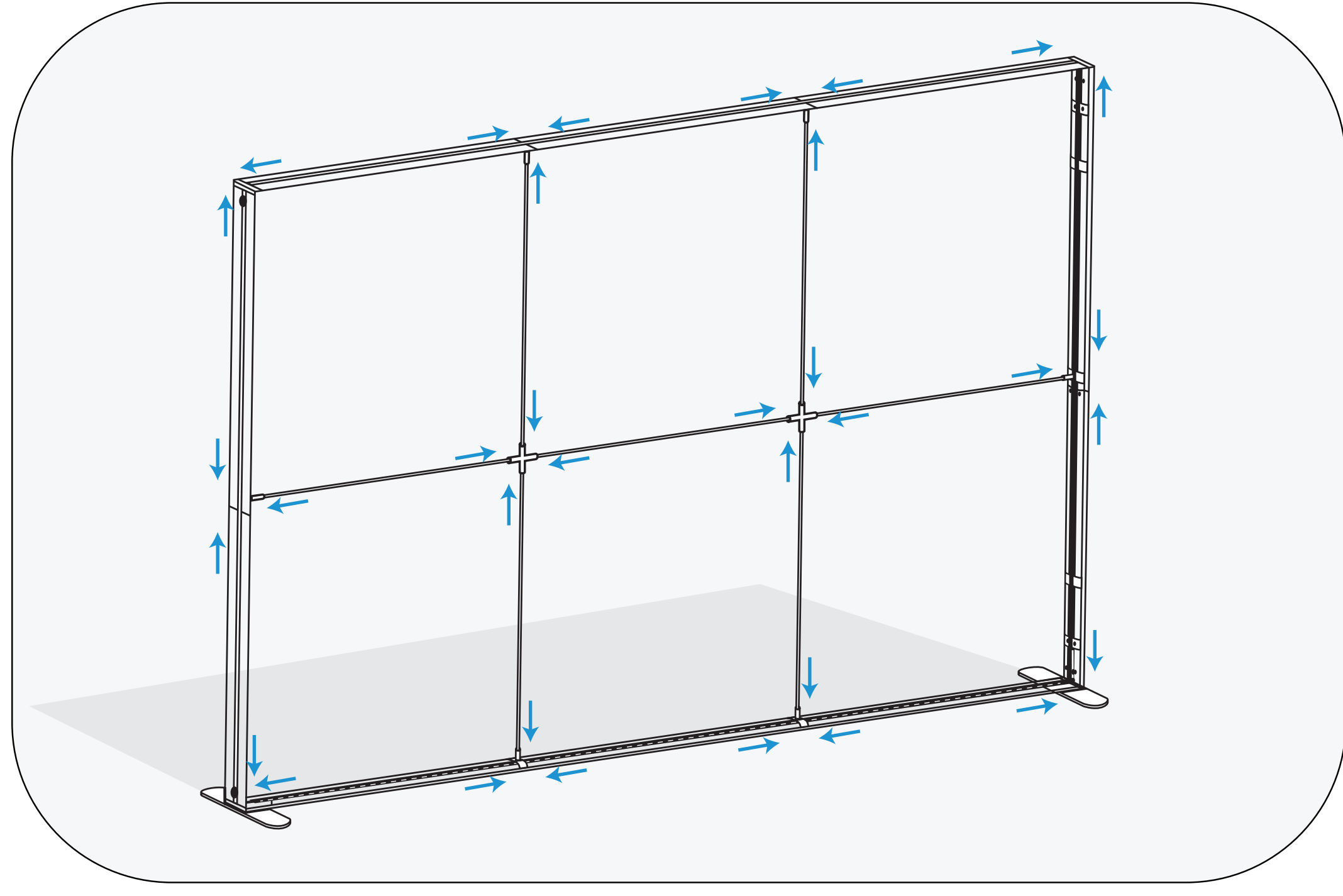

Step 1: Assemble Frame:

Insert corner connectors, join the frame sides, and tighten with an Allen key.

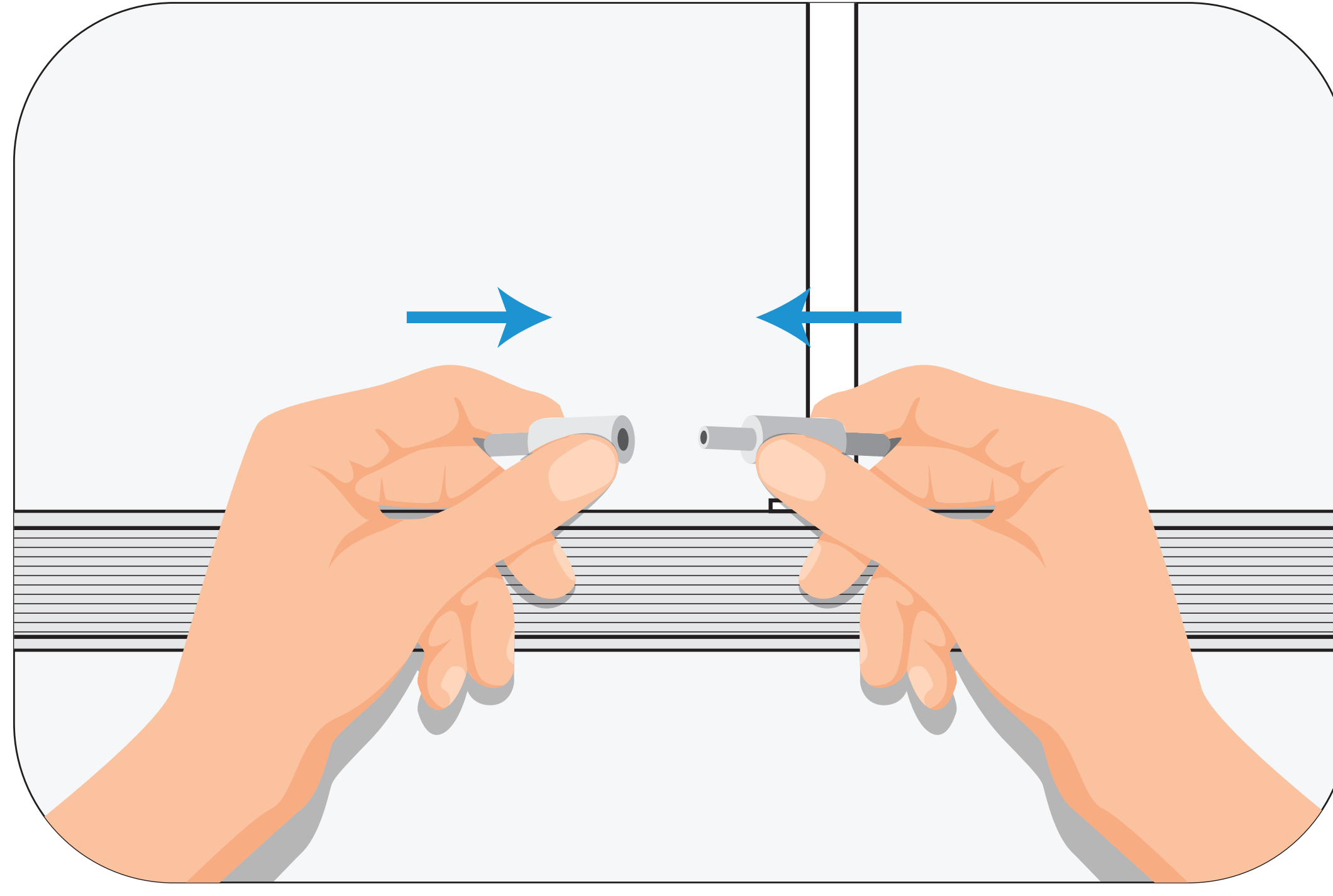

Step 2: Wire Lighting:

Connect LED light bars by matching male and female ends.

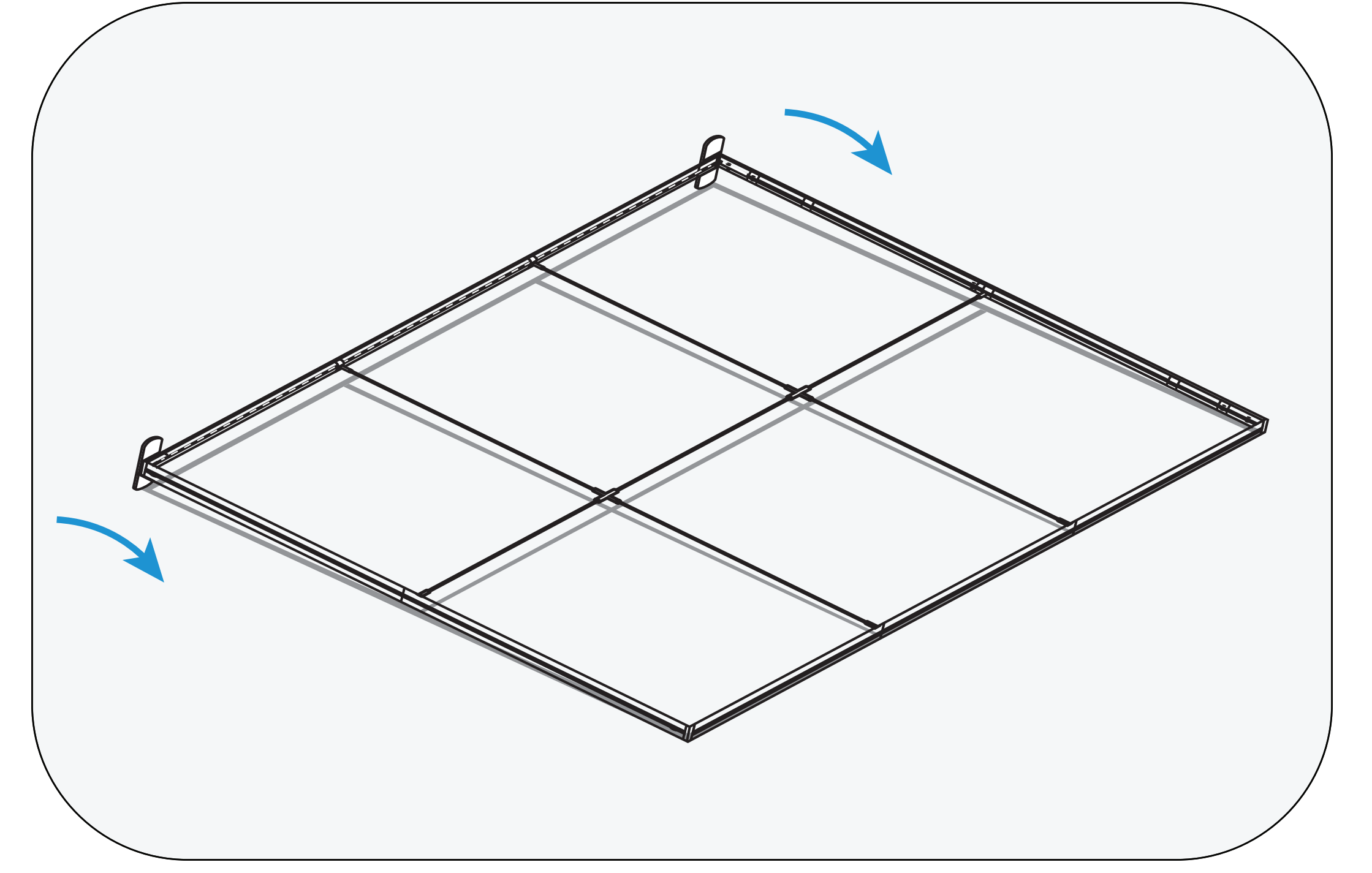

Step 3: Position Frame Face-Down:

Face-Down: Place the assembled frame face down.

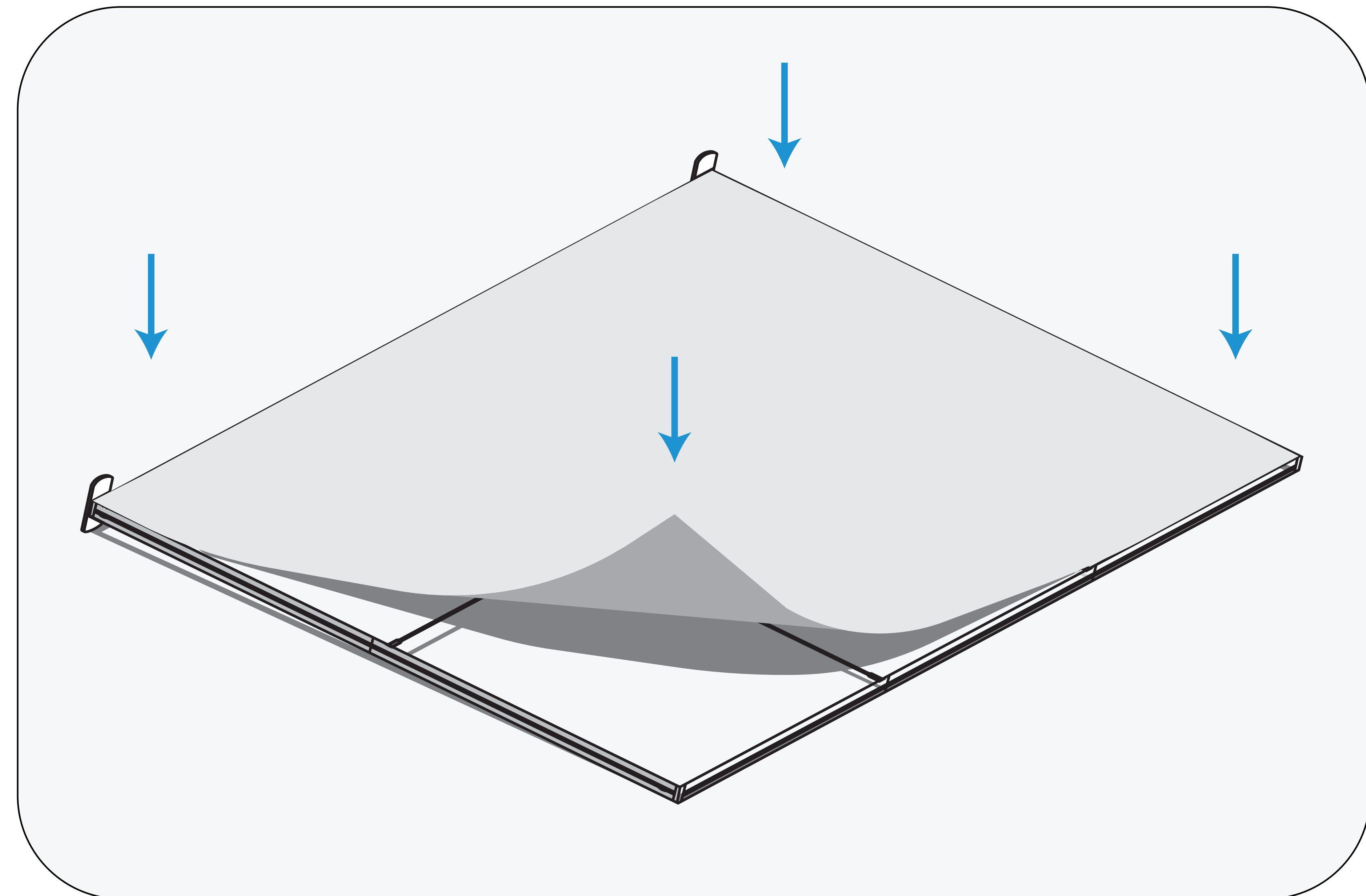

Step 4: Install Blockout Banner: Install the blockout banner from the back side of the frame.

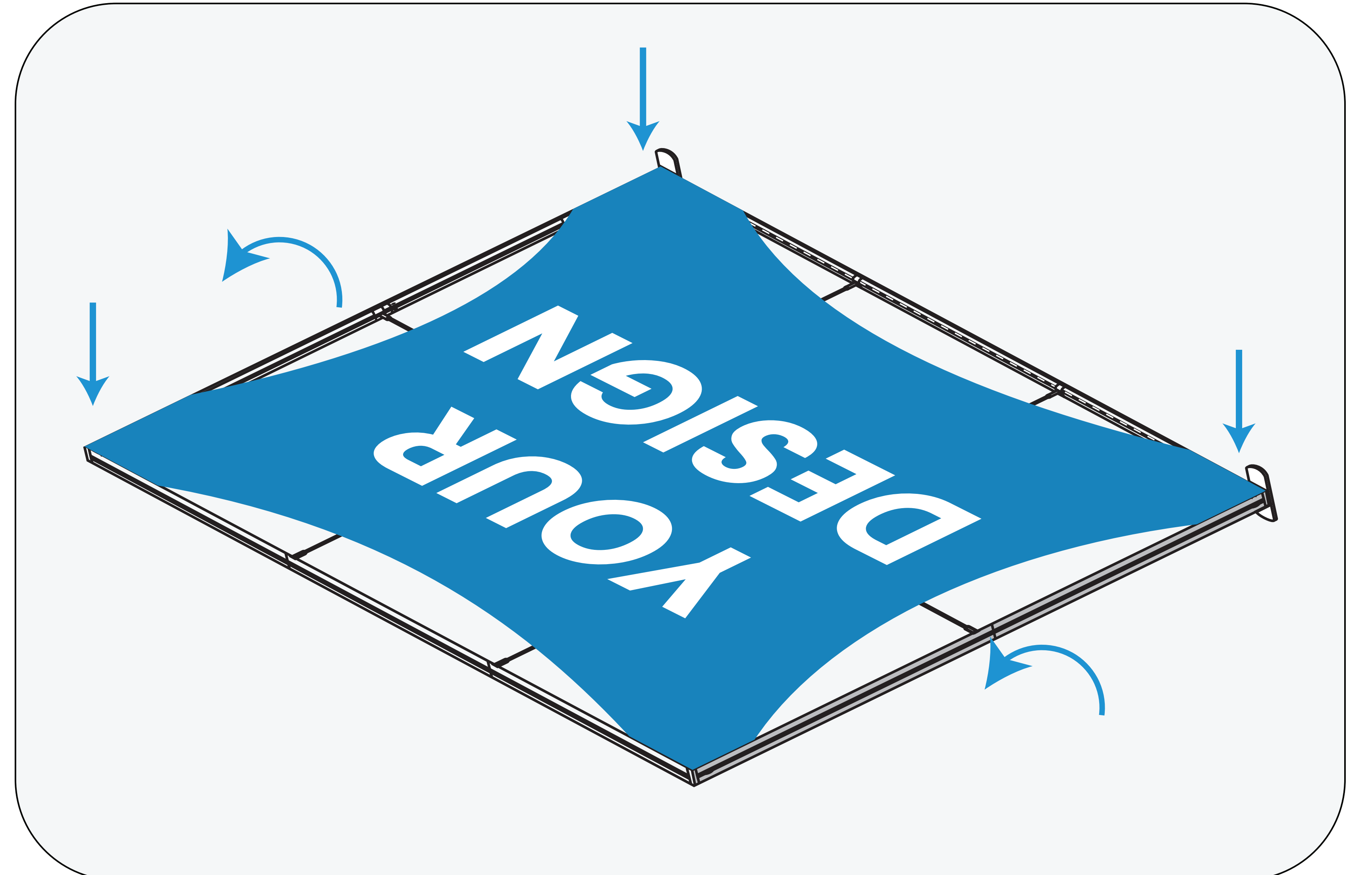

Step 5: Flip Frame Face-Up & Install SEG Graphic: Start at corners and tuck the silicone edges into the grooves.

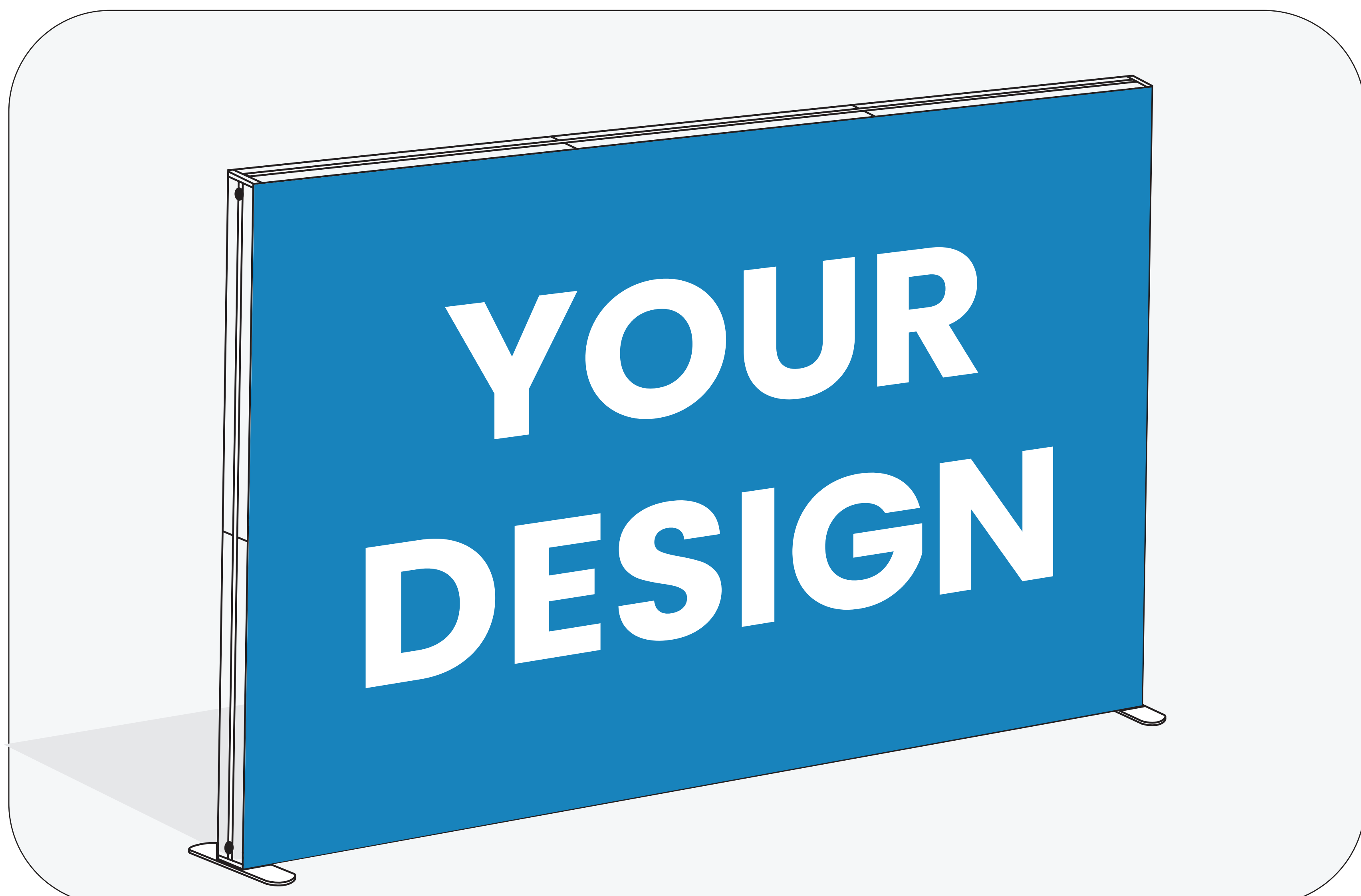

Step 6: Stand Frame Upright: Carefully raise the frame with the installed banners to an upright position.

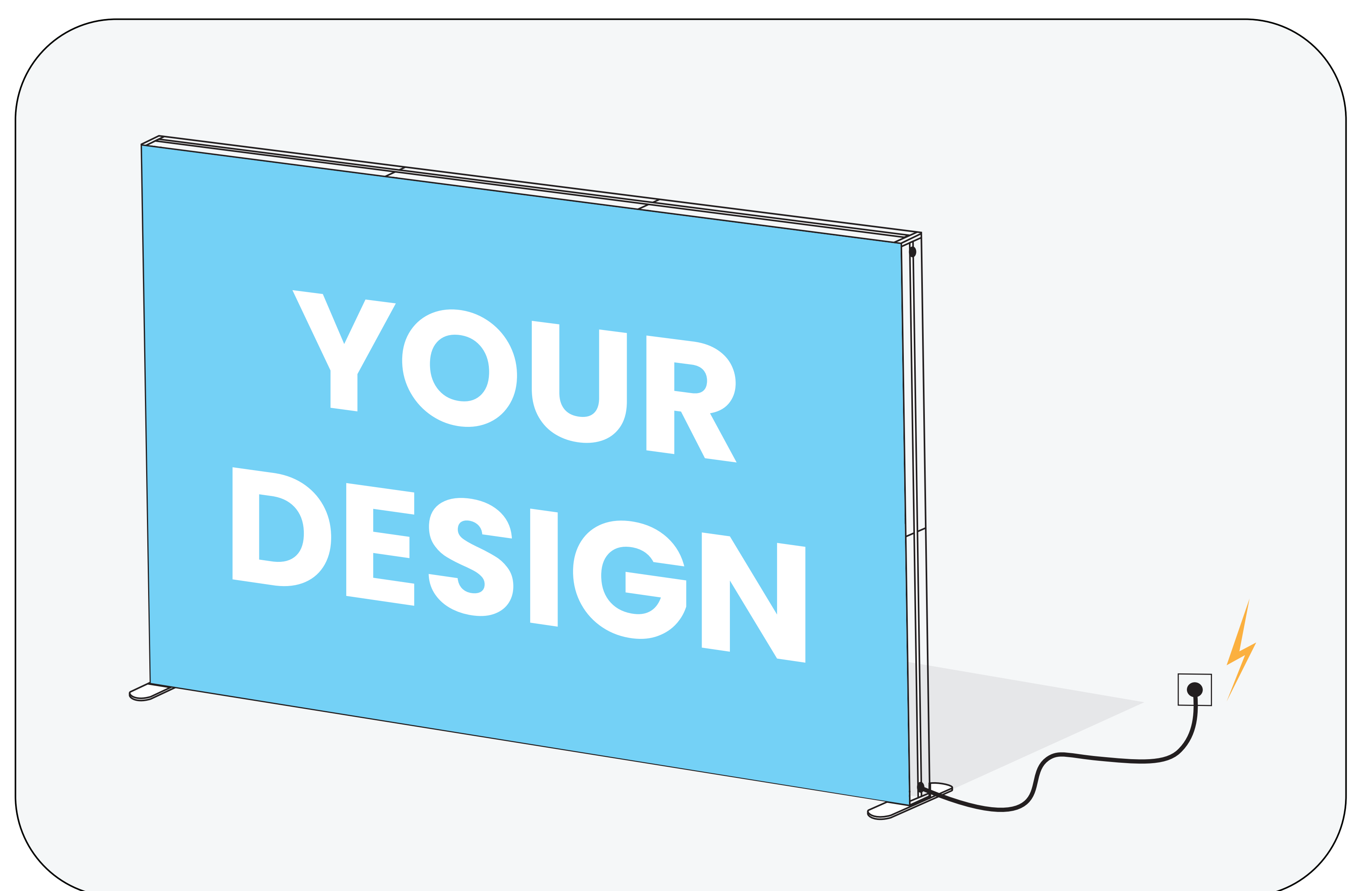

Step 7: Power On: Feed the cord through the frame hole, plug in, and confirm even illumination.